

**Nature's**  
AIR & WATER

# ClearStream

Personal Water Filter  
User Manual

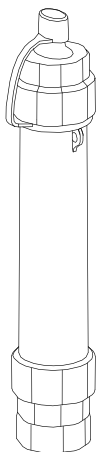

## I. Specifications

Description	Spec.
Temperature Range	34-104°F (0-40°C)
Filter Capacity	5,000L (1321 Gallons)
Flow Rate	Max 500mL/min
Pore Size	0.1µm

## II. Diagram

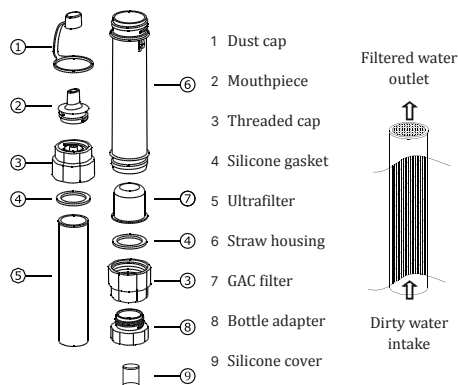

## III. Introduction

Drinking water from Nature's Air and Water ClearStream is quick, easy and convenient. This product requires no batteries, and filters up to 5,000 liters of water over its lifetime.

Nature's Air and Water ClearStream can be used to drink water directly from an open body of water, like a river, stream or lake. Its lightweight, compact and simple design makes it perfect for hiking, traveling, and camping.

## IV. Operating Instructions

### 1. Modes of Use

1) Draw in surface water directly through the intake of the Water-Straw.	2) Draw water from a container.
3) Draw water from a squeezable or rigid bottle threaded to the Water-Straw.	4) Connect and hang from a water-bag of water and let gravity fill a container.
5) Place inline or connect to the end of the tubing component in a hydration bag system.	

(Note: if the ultrafilter fibers are wet, then it's important to make sure there is no air gap between the fibers and water. The ultrafilter module must be flooded in order to allow drawn or pressurized flow through the filter.)

Please retain user manual for future reference

W-P-00-OD-001-02

## 2. Backflush after use

Upon first use or anytime the ClearStream is dry, please stand it up in drinking water for 1-2 mins or rinse the ClearStream under the tap from the "mouthpiece" side, until the inside is wet. And please do not drink the first filtered water (about 100ml, 4oz.).

If the ClearStream won't be used for an extended period of time, or if the flow rate or taste quality has diminished then it is recommended to backflush.

First remove the dust cap, then twist off the mouthpiece and thread on a squeezable plastic water bottle (e.g. ones commonly available at grocery stores) containing clean and safe water to the threaded cap. Some bottles need to be connected to the bottle adapter first. Then with the bottle connected, invert the ClearStream so that the intake is pointed downward.

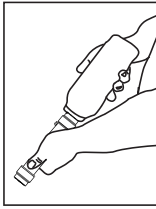

Gently squeeze the bottle so that water from the bottle flows slowly out of the straw intake. Backwashing is more effective if the pressure is pulsated. ~500ml (17oz) should be sufficient.

If the ClearStream is going to be stored for an extended period of time then it is highly advisable to disassemble and let air dry for 1-2 days prior to storing. Do not store in sun or in areas with elevated temperatures. It is recommended to store in a refrigerated environment (do not freeze if wet).

## 3. Storage

Store at normal temperature and humidity (32-104°F, <75%), avoid high temperature and humidity, and store at no lower than 32°F. The storage temperature must be higher than 32°F.

It is necessary to put the silicone cover on when storing whether unused or after cleaning.



## 4. Product Service Life & Filter Replacement

After filtering 1320 gal water (ideal conditions), or when the ClearStream becomes more difficult to draw water through, or offensive odors and tastes are no longer removed, it has reached its recommended service life. Suggest replacing with a new Nature's Air and Water ClearStream water filter. Visit our website at [www.naturesairandwater.com](http://www.naturesairandwater.com) for more information.

## V. Caution

To ensure long life use with relatively clean and turbid free surface water.

Never use ClearStream to filter seawater or oil contaminated water, including water from mining tailing ponds or from near large agricultural operations. Careless or unintended use may result in damaging this product.

Discard this product if any of the components become cracked or damaged.

This product must not be used by children without adult supervision.

Do not drop the product in polluted water as this might contaminate the filter outlet.

Always keep the mouthpiece covered with the provided dust cap when product is not in use.

## VI. Disclaimer

Nature's Air and Water ClearStream is designed to filter fresh water. The longevity and performance of the ClearStream is tested under standard laboratory conditions. User assumes all risk when using this personal water filter.

Any damages caused by using or misusing are not the responsibility of Nature's Air and Water. The effectiveness of ClearStream may be limited by environmental or hygienic conditions, please avoid incorrect operations as below (including but not limited):

1. Use of the personal water filter with dirty hands.
2. Backflushing with contaminated water.
3. Using with salt or polluted water.
4. Backflushing with excessive pressure (>15psi).
5. Not used as instructed or intended.
6. Storing the personal water filter for extended periods of time in a warm environment while in a wet condition.
7. Exposing the personal water filter to extreme heat or allowing it to freeze when saturated with water.

Read the user manual carefully before using. Nature's Air and Water ClearStream is a personal water filtration device. The quality of the filtered water is not guaranteed if the product is submitted to conditions other than those advised for proper use.

---

Web: [www.naturesairandwater.com](http://www.naturesairandwater.com)  
eMail: [support@naturesairandwater.com](mailto:support@naturesairandwater.com)

---